

E 8th St

E

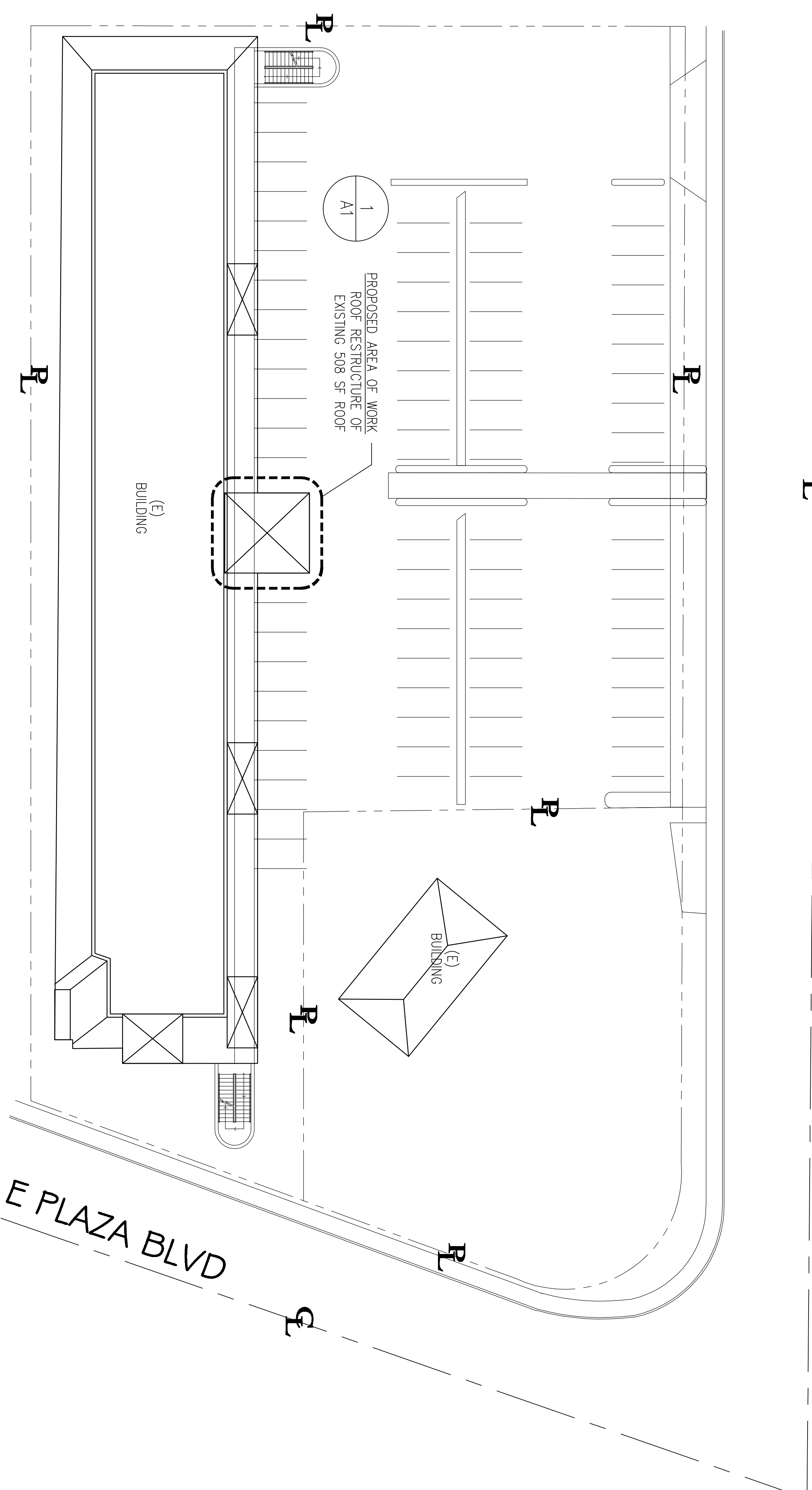

**1**  
1'-20"

# SITE PLAN

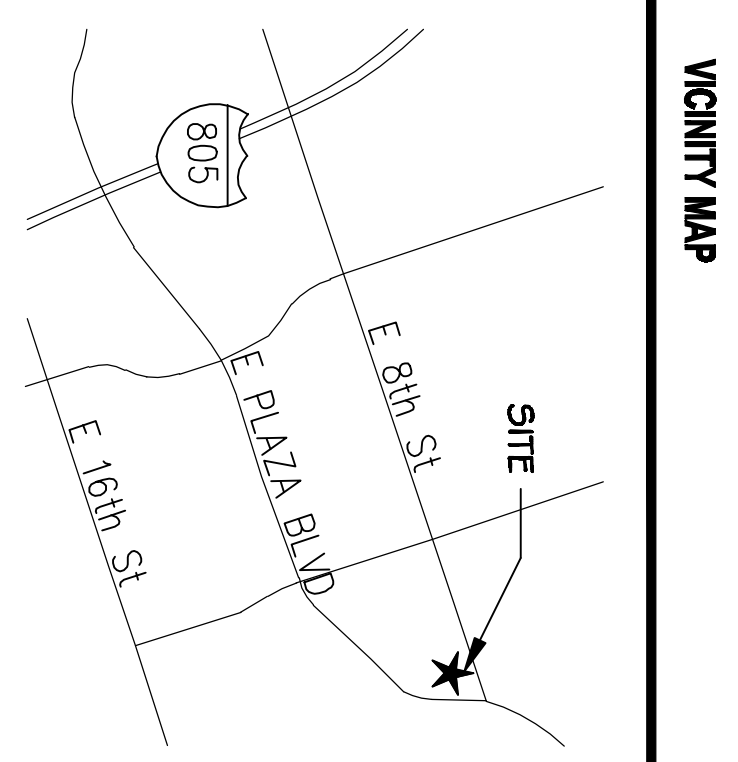

**VICINITY MAP**

**OWNER INFORMATION**

NAME: DANILO J. TULAGAN  
 ADDRESS: 3400 E 8th St, NATIONAL CITY, 91950  
 PHONE: 619-339-4831  
 EMAIL: Pd.2020@GMAIL.COM

**CONTACT INFORMATION**

NAME: PETE TULAGAN  
 ADDRESS: 2801 HILMINGBERG St, CHULA VISTA, 91915  
 PHONE: 618-307-2732  
 EMAIL: Pd.2020@GMAIL.COM

**PARCEL INFORMATION**

APN: 669-101-09-00  
 SITE ADDRESS: 3400 E 8th St, NATIONAL CITY, 91950  
 ZONING: MXD-1 - H35  
 BUILDING TYPE: V  
 OCCUPANCY GROUP: B

**PROJECT SCOPE**

PROPOSED AREA OF WORK RECONSTRUCTION OF EXISTING 508 SF DAMAGED ROOF STRUCTURE DUE TO FIRE

**PERVIOUS AREA INFORMATION**

PERVIOUS SURFACE AREA TABLE			
SITE ID	PERVIOUS ITEM	DIMENSIONS	NOTES

PERVIOUS ELEMENT MANUFACTURER: \_\_\_\_\_  
 PERVIOUS ELEMENT SLOPE AND DIRECTION OF SLOPE: \_\_\_\_\_  
 MAINTENANCE PROGRAM: \_\_\_\_\_  
 PERVIOUS ELEMENT CROSS SECTION LOCATED IN SHEET: \_\_\_\_\_  
 CONSTRUCTED PERVIOUS SURFACES SHALL NOT BE SEALED

**IMPERVIOUS AREA INFORMATION**

IMPERVIOUS SURFACE AREA TABLE				
SITE ID	IMPERVIOUS ITEM	DIMENSIONS	NEW OR REPLACED AREA (sq ft)	EXISTING AREA (sq ft)
1	STRUCTURE + OVERHANGS	20'-4-1/2" x 24'-11-1/2"	-	508.5
2	SFD			
3	DRIVEWAY			
4				

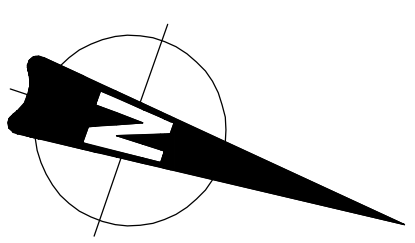
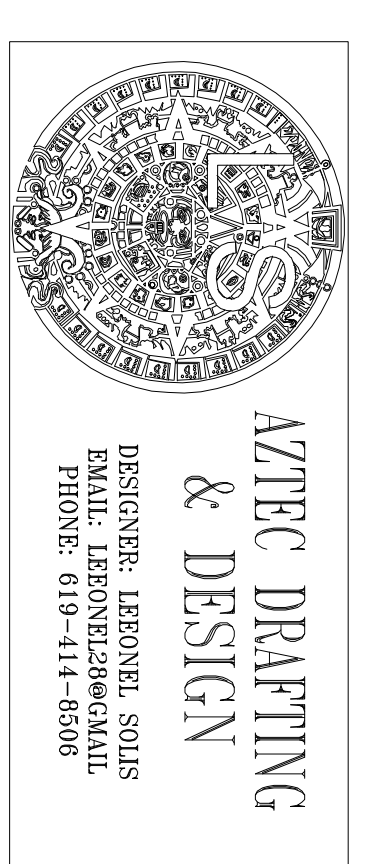

ENGINEERING SCALE: 1" = 20'

**SHEET NAME**

Sheet No.	SHEET NAME
SP-1	SITE PLAN
A01	OVERALL FLOOR PLAN - FIRST FLOOR
A02	OVERALL FLOOR PLAN - SECOND FLOOR
A1	FLOOR PLAN
A3	ELEVATIONS - FRONT
A5	ROOF PLAN / TRUSS LAYOUT
2	ROOF FRAMING
CS-1	MIN. CONSTRUCTION SPECIFICATIONS

**CODE COMPLIANCE**

PROJECT DESIGNED BASED ON THE FOLLOWING CODES:  
 2017 CALIFORNIA MECHANICAL CODE (CMC)  
 2019 CALIFORNIA MECHANICAL CODE (CMC)  
 2019 CALIFORNIA PLUMBING CODE (CPC)  
 2019 CALIFORNIA FIRE CODE (CFC)  
 2019 CALIFORNIA BUILDING CODE (CBC)  
 2017 NATIONAL ELECTRICAL CODE (NEC)  
 2017 NATIONAL ELECTRONIC CODE (NEC)  
 2019 CALIFORNIA GREEN BUILDING STANDARDS (CALGREEN)  
 2019 CALIFORNIA GREEN BUILDING STANDARDS (CALGREEN)  
 AND ALL CITY OF NATIONAL CITY AMENDMENTS.

SPECIFY AS INDICATED IN C-FIR FORM (TITLE 24):

SPECIFY AS INDICATED IN C-FIR FORM (TITLE 24):

- DUCT SEALING (Y or N)
- REFRIGERANT CHARGE (Y or N)
- COOLING SYSTEM AIRFLOW (Y or N)
- COOLING SYSTEM UNIT FAN EFFICACY (Y or N)
- COOLING SYSTEM SEER AND/OR EER ABOVE MIN. (Y or N)
- WHOLE-BUILDING VENTILATION AIRFLOW (Y or N)
- BUILDING ENVELOPE AIR LEAKAGE (Y or N)
- QUALITY INSULATION INSTALLATION (Y or N)
- OTHER (SPECIFY BELOW)

**COVER SHEET & SITE PLAN**

**DANILO J. TULAGAN**  
**TENANT IMPROVEMENT**  
 3400 E 8th St, NATIONAL CITY CA 91950  
 APN: 669-101-09-00  
 UTILITY: SDG&E  
 AJH: NATIONAL CITY

DRAWINGS PROVIDED BY:  
**AZTEC DRAFTING & DESIGN**  
 DESIGNER: LEONEL SOLIS  
 EMAIL: LEONEL28@GMAIL.COM

**AZTEC DRAFTING & DESIGN**  
 9119 MARCHE RD, SUITE 115  
 SPRING VALLEY, CA 91977  
 TEL: 619-414-8506

REVISION	DATE
0	01/31/2022

PROJECT NO. P0014  
 SHEET NO. SP-1



OVERALL FLOOR PLAN - FIRST FLOOR

1/8" = 1'-0"

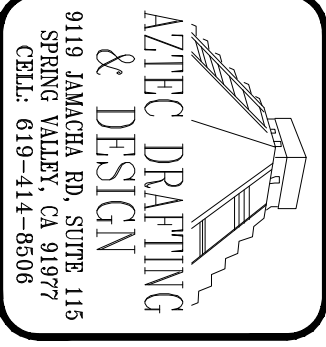

919 AMARCO RD. SUITE 115  
SPRING VALLEY, CA 91977  
TEL: 619-414-8006

DRAWINGS PROVIDED BY:  
**AZTEC DRAFTING & DESIGN**  
DESIGNER: LEONEL SOLIS  
EMAIL: LEONEL296@GMAIL.COM

*Leonel Solis*

**DANILO J. TULAGAN**  
**TENANT IMPROVEMENT**  
3400 E 8th St, NATIONAL CITY CA 91950  
APN: 669-101-09-00  
UTILITY: SDG&E  
AJH: NATIONAL CITY

**OVERALL FLOOR PLAN  
FIRST FLOOR**

REVISION	DATE
0	01/31/2022

PROJECT NO.  
P0014

SHEET NO.  
**A01**

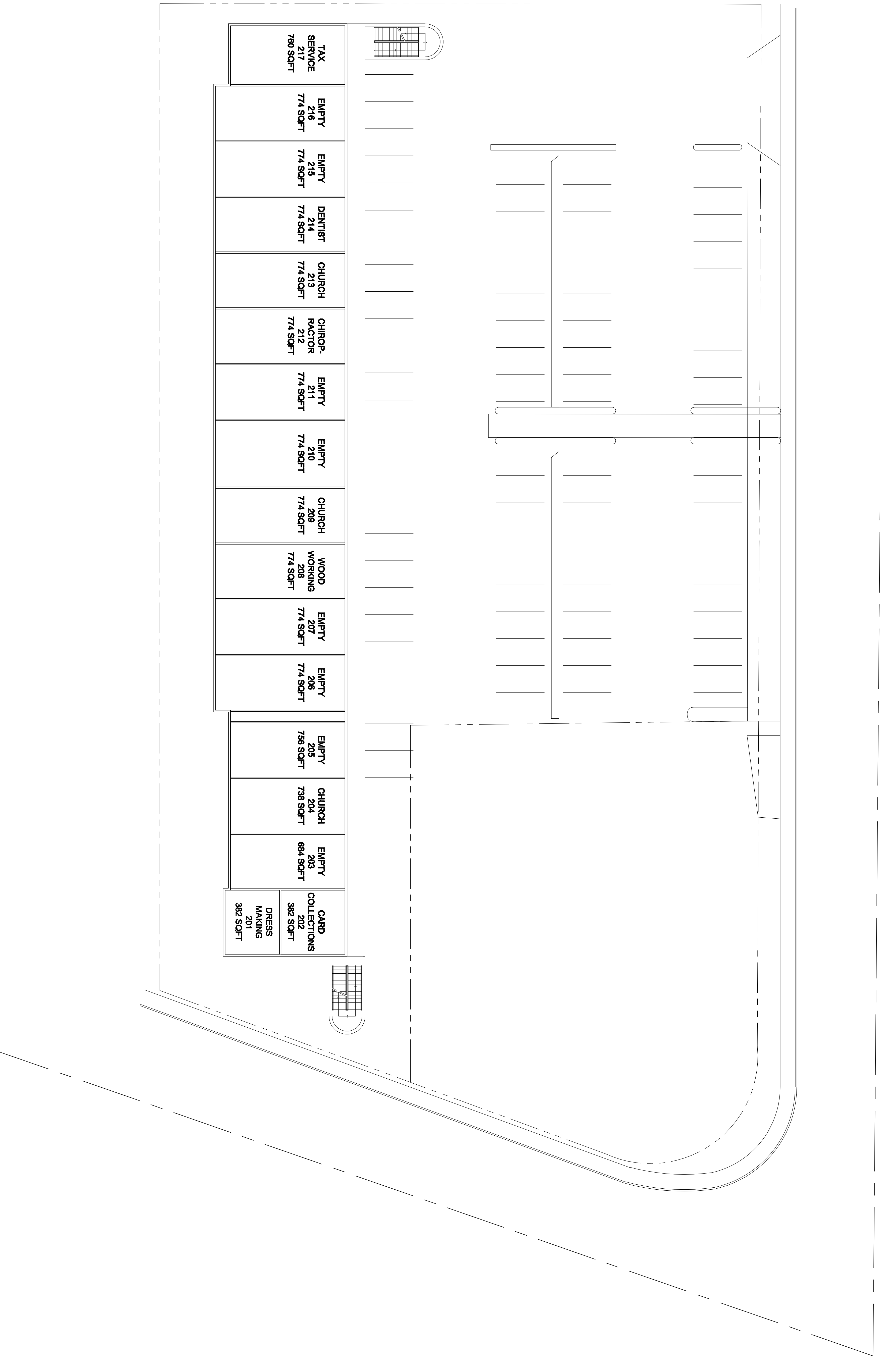

**OVERALL FLOOR PLAN - SECOND FLOOR**  
 1/8" = 1'-0"